



## Brindley Place, Uxbridge, UB8 2FA

- Modern apartment
- 7am -7pm Concierge
- Canal side development
- Parking offered
- Underfloor heating throughout
- High specification
- Gated development
- EPC Rating - B
- Property now furnished\*
- Viewing recommended

**£1,395 PCM**

Cameron Estate Agents  
195 High Street,  
Middlesex, Uxbridge, UB8 1LB

E: [uxbridge@cameron.co](mailto:uxbridge@cameron.co)  
T: 01895252000

[www.cameron.co](http://www.cameron.co)



**Description**

Cameron are delighted to offer this newly built one bedroom apartment in the highly sought after development of Union Park. This high specification apartment briefly comprises a large hallway leading to the double bedroom with fitted wardrobes, open plan kitchen/living area and a luxury fitted shower-room. This apartment also includes integrated appliances in the kitchen including fridge freezer, dishwasher, microwave and ample storage. Jessop Court is conveniently situated close to a number of local amenities including Hillingdon Hospital, Brunel University and Stockley Business Park and the West Drayton Elizabeth Line. This is an exclusive development within a tranquil canal side setting yet provides a 23 minute hop into the heart of London's West End. Offered to the market furnished and available October 2026, parking included.

**IMPORTANT NOTICE**

These particulars have been prepared upon information supplied by the Vendor and should be verified by your surveyors and solicitors. In accordance with the Property Misdescriptions Act 1991 we have prepared these sales particulars as a general guide to give a broad description of the property. They are not intended to constitute part of an offer or contract. We have not carried out a structural survey and the services, appliances and specific fittings have not been tested. All photographs, measurements, floor plans and distances referred to are given as a guide only and should not be relied upon for the purchase of carpets or any other fixtures or fittings. Lease details service charge and ground rent (where applicable) are given as a guide only and should be checked and confirmed by your solicitor prior to exchange of contract

## Third Floor

Approx. 42.3 sq. metres (455.2 sq. feet)  
(excluding Balcony)

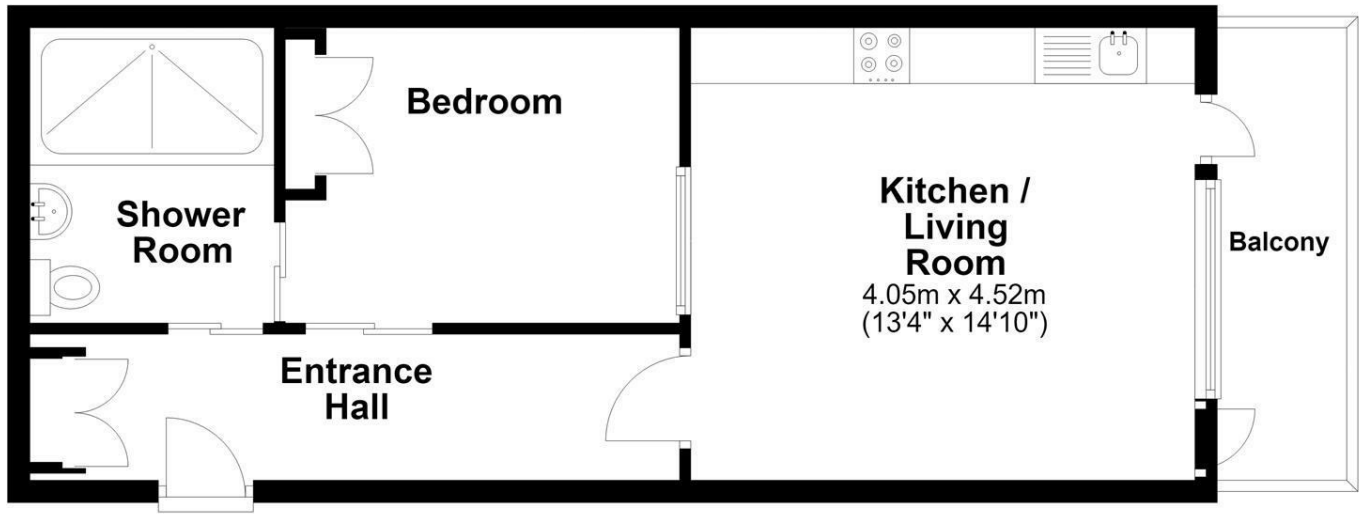

Total area: approx. 42.3 sq. metres (455.2 sq. feet)

# Cameron

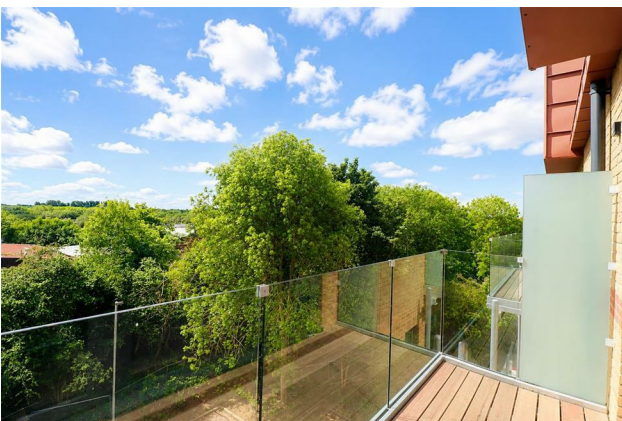

Whilst every care has been taken to ensure the accuracy of these particulars, none of the statements contained herein are to be relied upon as representations of fact. These particulars do not constitute an offer or contract.